

FOR SUBLEASE

# 7525 W CAMPUS RD

7525  
W CAMPUS RD  
New Albany, OH 43054



## PROPERTY OVERVIEW

### 50,545 SF AVAILABLE

- + Sublease runs through May 31, 2023
- + Space is divisible and available for smaller sublets
- + 10,000 SF executive area separated from balance of the space
- + 10/1,000 SF parking ratio
- + Open floor plate, single story—perfect for call centers
- + Monument signage available or potential for building signage

[www.cbre.us/columbus](http://www.cbre.us/columbus)

**CBRE**

# FOR SUBLEASE 7525 W CAMPUS RD



## BUILDING HIGHLIGHTS

7525 W Campus Road is a single story, open floor building ideally suited for a single tenant call center user.

- + Built in 2013 by Daimler
- + Standby generator backs up 2/3 of critical areas (not training areas)
- + Raised floor data room has 2 liebert units, a UPS and Fenwal Net 6000 fire suppression
- + Furniture can be made available
- + 16 security cameras
- + 9' ceilings and full height perimeter glass
- + Situated on a multi-building campus in New Albany
- + Connected to the Ohio Third Frontier Network, a fiber optic network linking Ohio's colleges and universities and research and healthcare facilities with companies interested in research and development



## INTERIOR PHOTOS





# FLOOR PLAN

## UNFURNISHED

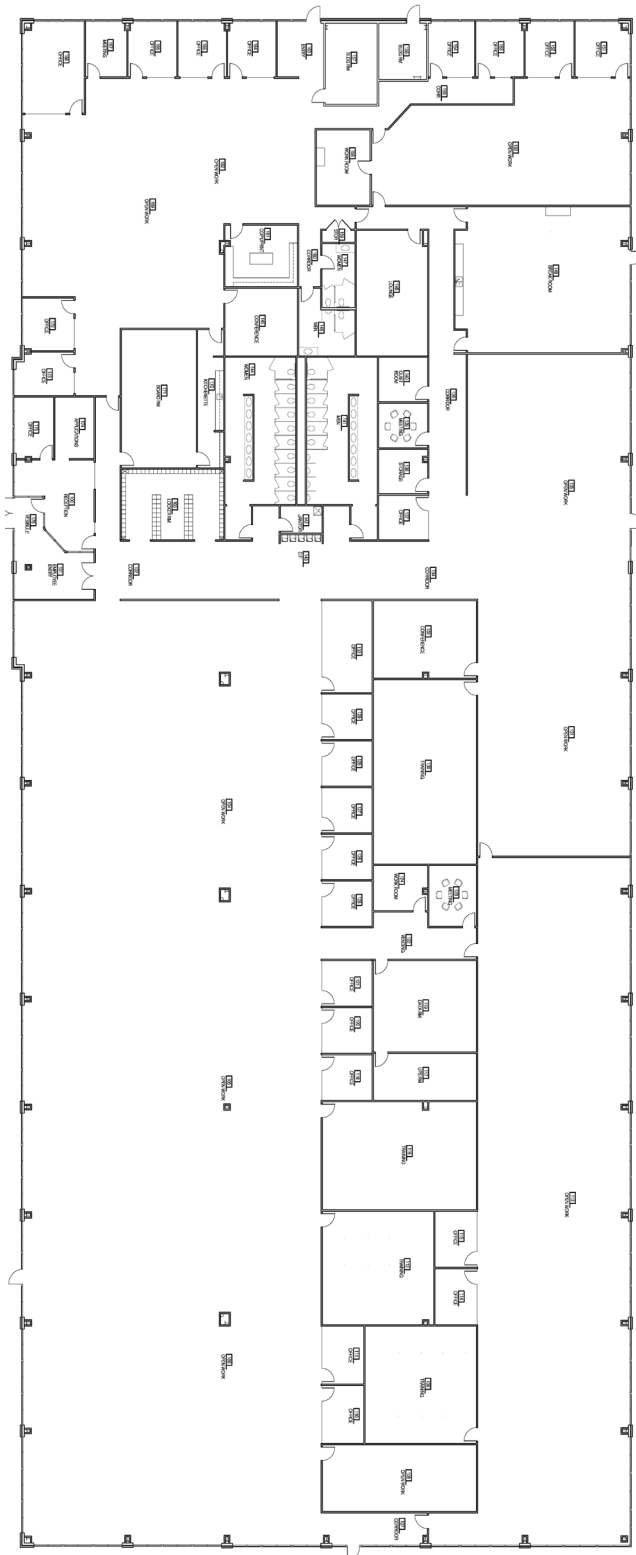

## FURNISHED—SEATING FOR 850 PEOPLE

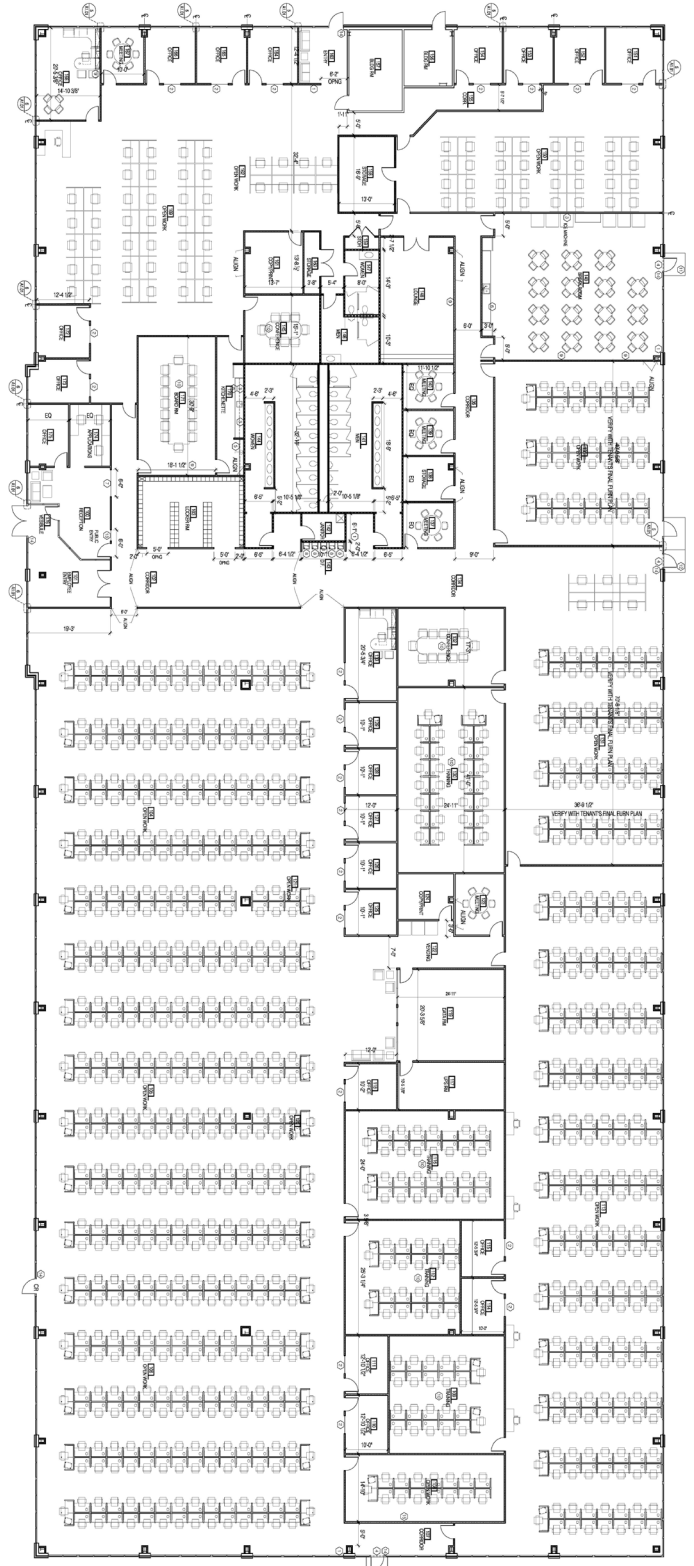

# FOR SUBLEASE 7525 W CAMPUS RD

7525  
W CAMPUS RD  
New Albany, OH 43054



## AMENITY MAP



## CONTACT US

### TODD GREINER

Senior Vice President  
+1 614 430 5013  
todd.greiner@cbre.com

### KATIE ZACHRICH

Associate  
+1 614 430 5094  
katie.zachrich@cbre.com

© 2018 CBRE, Inc. All rights reserved. This information has been obtained from sources believed reliable, but has not been verified for accuracy or completeness. You should conduct a careful, independent investigation of the property and verify all information. Any reliance on this information is solely at your own risk. CBRE and the CBRE logo are service marks of CBRE, Inc. All other marks displayed on this document are the property of their respective owners. Photos herein are the property of their respective owners. Use of these images without the express written consent of the owner is prohibited.